

Slave Housing Data Base

Building Name: Elk Hill Duplex Quarter – Building 2 (to south of Bldg. 1)

Evidence Type: Extant

Site ID: 037-0009

Historical Site Name: Elk Hill

County: Goochland

State: Virginia

Investigators: Dennis J. Pogue, Douglas W. Sanford

Institutions: Virginia Slave Housing Project

Project Start: 7/29/20 [7/31/20]

Project End: 9/4/20

Summary Description:

This brick, two story, four-bay, side-gabled outbuilding, with a centered interior chimney, is positioned parallel with and just to the south of the larger kitchen-quarter, within the home complex of the former Elk Hill plantation. The façade is symmetrical, with two doorways and two windows, which reflect a duplex plan to accommodate two separate enslaved households. Both rooms on each floor were heated by central interior fireplaces. Stairways rising along the exterior end walls led to the rooms above. The walls are laid in three-course common bond, capped by corbelled eaves on the front and rear. As with the adjacent kitchen-quarter, the brick walls were covered with a yellow/buff limewash, with red pigment applied to delineate the mortar joints. Later, the exterior surface was whitewashed, followed by a covering of white paint. The building measures 17.10.2 wide (north-south) and 34.1.0 long (east-west).

The building was extensively remodeled on the interior in the 20th century, which makes it difficult to discern original features and fabric, such as fireplaces and stairways. The partitions on both floors have been pierced to allow direct access between the rooms. The current stairway, which is of 20th century vintage, is located in the west room (1), but it is likely that stairways were originally positioned along each end wall, as in the kitchen-quarter. All of the fireplace openings are blocked. The doors and windows have all been replaced.

Principal Construction Type: Masonry – Brick

Two Story

Footprint:

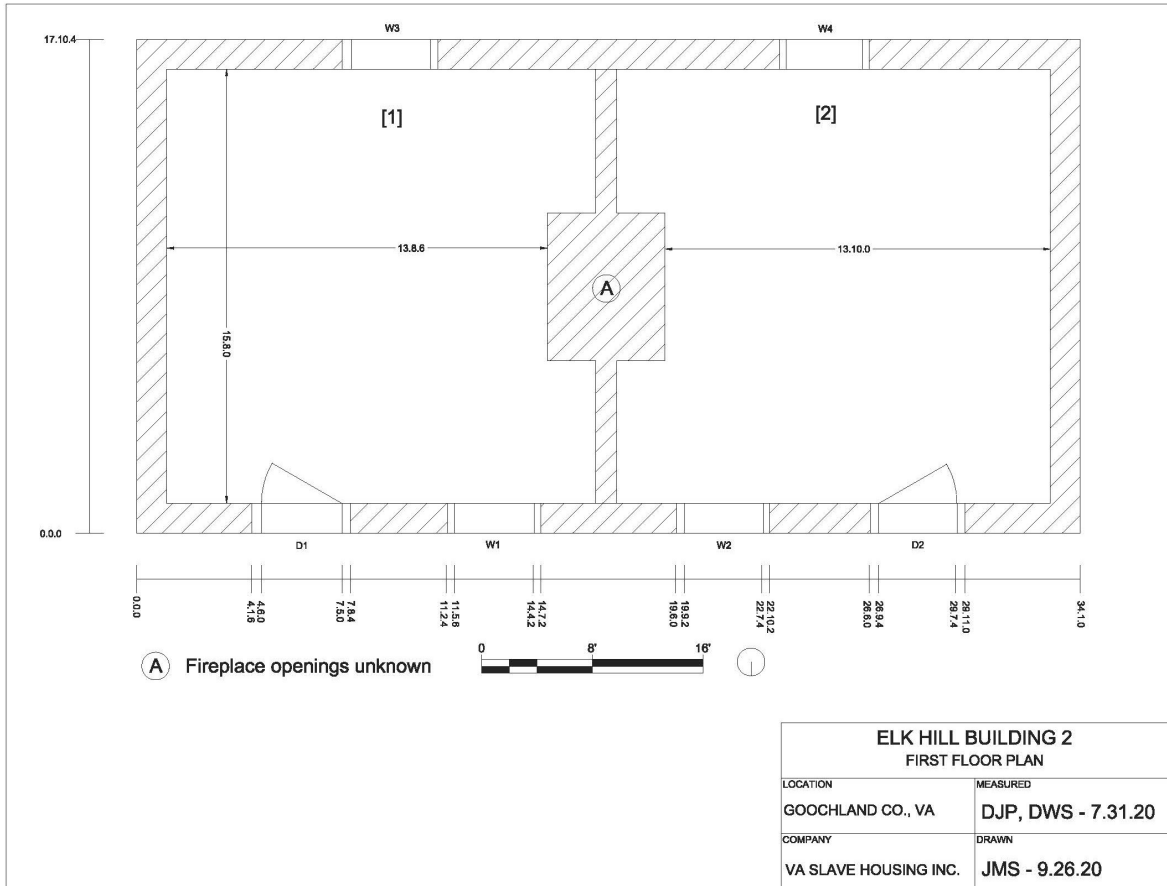

Number of Rooms: 4 total (2 down, 2 up)

- Dimensions:**
- (1) Downstairs, east: 15.10.1 (N-S) x 13.8.3 (E-W), 8.5.2 (H)
 - (2) Downstairs, west: 15.8.0 (N-S) x 13.10.0 (E-W), 8.5.2 (H)
 - (3) Upstairs, east: 15.9.3 (N-S) x 13.9.0 (E-W), 7.11.3 (H)
 - (4) Upstairs, west: 15.9.3 (N-S) x 13.11.2 (E-W), 7.11.3 (H)

Doors: 2 original doorways measured; other interior doorways are either later insertions (through the medial wall) or for modern closets

	Rm. 1, N (1)	Rm. 2, N (2)
Type:	2/1/2 panel	2/1/2 panel
Dimensions:	2.11.0 (W) 7.0.2 (H)	2.10.0 (W) x 6.9.2 (H)
Hardware:	5 knuckle butt hinges	5 knuckle butt hinges
Swing:	Out	In
Replacement:	Yes	Yes

Windows: 10

	Rm. 1, N (1)	Rm. 2, N (2)	Rm. 1, S (3)
Type:	6/6, double hung sash	6/6, double hung sash	6/6, double hung sash
Dimensions:	2.9.2 (W) x 4.5.2 (H)	2.9.2 (W) x 4.5.1 (H)	2.10.1 (W) x 4.5.2 (H)
Hardware:	None	None	None
Shuttered/ Slide/ Swing:	Replacement	Replacement	Replacement

Windows: *continued*

	Rm. 2, S (4)	Rm. 3, N (5)	Rm. 4, N (6)
Type:	6/6, single hung sash	6/6, single hung sash	6/6, single hung sash
Dimensions:	2.10.0 (W) x 4.6.0 (H)	2.10.2 (W) x 4.5.2 (H)	2.10.2 (W) x 4.5.2 (H)
Hardware:	None	None	None
Shuttered/ Slide/ Swing:	Replacement	Replacement	Replacement

	Rm. 3, S (7)	Rm. 4, S (8)	Rm. 3, E (9)
Type:	6/6, single hung sash	6/6, single hung sash	1 pane, fixed sash
Dimensions:	2.10.2 (W) x 4.5.2 (H)	2.10.2 (W) x 4.6.0 (H)	1.7.2 (W) x 1.11.0 (H)
Hardware:	None	None	None
Shuttered/ Slide/ Swing:	Replacement	Replacement	Later insertion: frame measures 2.0.0 (W) x 2.4.2 (H)

	Rm. 4, W (10)
Type:	1 pane, fixed sash
Dimensions:	1.7.2 (W) x 1.11.0 (H)
Hardware:	None
Shuttered/ Slide/ Swing:	Later insertion (see Window 9)

EXTERIOR

Foundation:

Continuous Masonry: Brick
Thickness: 1.1.0
Height: NA
Bond: Common, 3 course
Mortar Type: Sand – Clay
Joint: Overhand struck
Repaired: Yes

Porch: Yes, on north façade, removed – later addition associated with concrete pad (not shown)

Roof:

Roof Form: Gable
Roof Covering: Slate shingles
Roof Framing:
Exposed: Yes, but not fully visible or accessible
Form: Common Rafters
Rafter Number: not determined
Rafter Dimensions: approx. 3 x 4, 4 x 4 inches
Collar Ties: No

Building Height: @ NE corner
Ground to Bottom of cornice: 18.6.3
Ground to Top of Eave: 19.7.0

Walls:

Masonry: Brick
Number of Courses: NA
Bond: Common, 3 course
Mortar Type: Sand – Clay
Joint: Overhand struck
Repaired: Yes

Chimney(s):

Chimney (1):
Material: Brick
Location: Interior – Center
Height: not accessible

INTERIOR

Wall Framing: NA

Wall Finish: Whitewash on brick, later covered with plaster

Fireplace (1): Center (on west wall)

Fireplace Material: Brick

Fireplace Overall Dimensions: 1.9.0 (E-W) x 5.4.2 (N-S)

Fireplace Opening Dimensions: NA; fireplace filled in & covered over

Hearth Material: NA

Hearth Dimensions: 1.10.0 (E-W) x 5.5.0 (N-S)

Fireplace (2): Center (on east wall)

Fireplace Material: Brick

Fireplace Overall Dimensions: NA; covered by later closet/bathroom additions

Fireplace Opening Dimensions: unknown

Hearth Material: NA

Hearth Dimensions: NA

Fireplace (3): Center (on west wall)

Fireplace Material: Brick

Fireplace Overall Dimensions: NA x 1.10.0 (E-W)

Fireplace Opening Dimensions: NA

Hearth Material: NA

Hearth Dimensions: 1.10.0 (E-W) x 5.3.0 (N-S)

Fireplace (4): Center (on east wall)

Fireplace Material: Brick

Fireplace Overall Dimensions: NA

Fireplace Opening Dimensions: NA

Hearth Material: NA

Hearth Dimensions: NA

Stairs: Yes, modern replacement on east gable end wall (Room 1, NE corner)

Type: Enclosed

Stairwell Dimensions: not measured, given modern date

Subfloor Pit: No

Floor: Wood (original flooring removed, replaced), now covered with carpet & linoleum

Dating:

Dendrochronology Date: NA

Other Date: Ca. 1820-1840

Dating Evidence:

Saw Marks: Sash sawn rafters

Nails: NA