

Slave Housing Data Base

Building Name: The Shade, Building 1 (log cabin portion to south)

Evidence Type: Extant

Site ID:

Historical Site Name: The Shade, The Shades, Locust Shade

County: Rappahannock

State: Virginia

Investigators: Dennis J. Pogue, Douglas W. Sanford

Institutions: Virginia Slave Housing Project

Project Start: 6/23/20 **Project End:** 6/23/20

Summary Description:

The log structure at the Shade is a one-and-one-half story, two-bay, single-cell cabin, measuring 17.1.0' by 16.4.0'. The building has a side-gable roof, currently covered in standing-seam metal, and is supported on a stone perimeter foundation. The cabin was originally heated by an exterior end chimney, which no longer survives. A round hole for a stove pipe centered on the south wall corresponds with a framed and infilled opening for the fireplace. The wall logs are hewn on both sides, left round at the top and bottom, and are joined with V-notches at the corners. The doorway and window in the east-facing façade are regularly spaced; a second window is centered on the rear wall. An enclosed ladder stair in the southwest corner of the downstairs room rises along the south wall to the garret above. The current stairway is a later addition, but the original stair likely was in the same location. It cannot be determined whether the garret was heated originally.

Based on the physical evidence, the cabin likely was constructed ca. 1840-1860. In the 20th century, a frame addition was erected against the north wall, and a doorway was cut through the end wall to provide direct interior access. A doorway and window in the east wall of the addition mirrors the condition in the log structure, and a shed roofed porch covers both doorways. A brick chimney for a stove is located along the south wall of the addition. On the second level, the end wall of the cabin was cut to create a doorway connecting with the garret of the addition.

After the chimney was removed, it's likely that another structure, perhaps a kitchen addition, was attached to the south cabin wall. This addition probably had a flue for a woodstove, with another stove pipe extending into the cabin (Room 1). The pipe came through the garret's floor, evidenced by a patched opening, and extended out through the roof near the gable end, where another patch occurs between the end rafter and the first rafter to the north.

Principal Construction Type: Log

One and One-Half Story

Footprint:

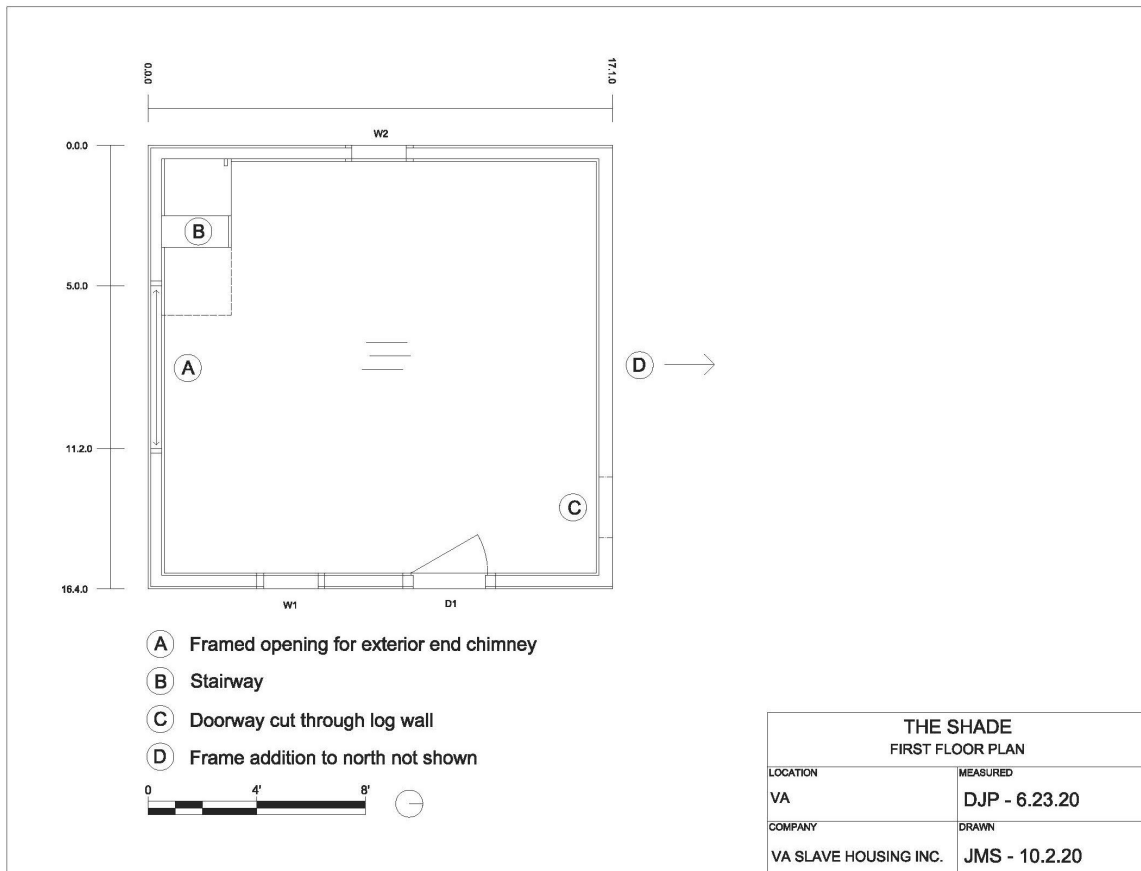

Number of Rooms: 2 total [20th century addition not shown]

Dimensions:

(1) Downstairs: 15.4 (E-W) x 16.0.0 (N-S), Height: 6.4.3 (to bottom of ceiling joist)

(2) Upstairs: 15.3.3 (E-W) x 16.1.0 (N-S); Height: 9.10.1 (floor to roof peak)

Doors: 3

	Rm. 1, E (1)	Rm. 1, N (2)	Rm. 2, N (3)
Type:	Board & batten - 5 boards, 3 battens (chamfered)	Doorway only; inserted opening for access to frame addition	Doorway only; inserted opening in modern era for frame addition
Dimensions:	2.7.3 (W) x 5.6.2 (H)	2.8.0 (W)	2.6.0 (W) x 6.1.0 (H)
Hardware:		NA	NA
Swing:	In	NA	NA
Replacement:	Possible period door (now on floor)	Modern era passthrough	Modern era passthrough in garret

Windows: 3

	Rm. 1, E (1)	Rm. 1, W (2)	Rm. 2, S (3)
Type:	4/4, Single hung sash (top sash fixed)	Unknown, sash removed	Unknown, sash removed
Dimensions:	1.11.3 (W) x 3.2.3 (H)	1.11.3 (W) x 3.2.3 (H)	1.8.2 (W) x 4.7.0 (H)
Hardware:	None	Unknown	Unknown
Shuttered/Slide/Swing:	NA; Reworked surround, with wire nails	NA; Reworked surround, with wire nails	NA; later insertion, after chimney removed

EXTERIOR

Foundation:

Continuous Masonry: Stone (field stones)

Thickness: NA

Height: 1.11.0 @ SE corner (log); 1.4.0 @ south gable end (center); 1.6.0 @ NE corner

Bond: Random
Mortar Type: Clay Only (mud mortar visible @ SE corner), some stones dry laid
Joint: NA
Repaired: Yes

Porch: No

Location: Current added porch on east façade, not shown

Roof:

Roof Form: Gable

Roof Covering: Standing seam sheet metal

Roof Framing: Log section

Exposed: Yes

Form: Common Rafters

Rafter Number: 8 pairs

Rafter Dimensions: Pole rafters ~ 3.5 to 4.0 inches diameter

Collar Ties: No

Building Height:

@ SE corner (log section)

Ground to top of plate: 12.1.2

Ground to Apex: 18.6.2 (south gable end)

Walls:

Log:

Dimensions: ~ 5 in. thick

Finish: Round (top & bottom) – Hewn Flat Sides – Debarked

Notching: V

Chinking: Mud (originally)

The exterior walls are covered with board-and-batten siding that has been whitewashed, and is attached with wire nails. The addition of the frame section (to the north) captured an exterior wall surface of board-and-batten siding on the north end of the cabin, indicating that the log building had earlier received this type of exterior siding. The same circular sawn and wire nail materials were used with the frame addition, suggesting that this structure was built not long after the siding of the log cabin.

Chimney(s):

Chimney (1): Log section (Period 1)

Material: Unknown (likely stone)

Location: Exterior – End (south gable)

Height: Unknown, removed

INTERIOR

Wall Framing: Log

Wall Finish: Whitewash – note later addition of nailed wood slats, with whitewash

The ground floor room has 7 exposed round log ceiling joists (flattened on top) and 2 gable end logs/joists. The ceiling joists have whitewash, as do the undersides of the garret's floorboards.

Fireplace (1): End – removed

Fireplace Material: Unknown, removed

Fireplace Overall Dimensions: 6.2.0 (E-W) x unknown (N-S)

Fireplace Opening Dimensions: unknown, except height: 4.2.0 above floor

Stairs: Yes – SW corner (original location)

Type: Ladder – Enclosed

Stairwell Dimensions: 1.11.0 (N-S) x 5.9.0 (E-W)

Number of Treads: 6

Stair Tread Dimensions: 2.0.2 (L) x 0.11.2 (W) x 0.9.0 (H)

Subfloor Pit: No

Floor: Wood

Floorboards Dimension: NA

Dating:

Dendrochronology Date: NA

Other Date: Ca. 1840-60

Dating Evidence:

Saw Marks: Circular Sawn

Nails: Mature Machine Cut

Field Notes

Exterior

The cabin is oriented almost exactly north-south by east-west. Taken at the building's SE corner and looking to the rear, SW corner, the compass bearing is 268⁰, almost due west.

Interior

Room 1: Measuring from the north gable end joist, center to center, produces the following distances between joists: to exposed joist #1, 2.3.0; to exposed joist #2, 2.0.0;

to exposed joist #3, 2.4.0; to exposed joist #4, 2.2.0; to exposed joist #5, 2.2.0; to exposed joist #6, 2.2.0; to exposed joist #7, 2.4.0; to south gable end siding, 2.2.0.

The exterior door (Door 1) on the east wall originally was hinged on the opening's southern side. The current doorframe is reworked, using wire nails. Upon the addition of the frame structure to the north, a doorway (pass-through) was inserted towards the east end of the cabin's north gable end wall.

Garret, Room 2: This half-story portion of the log cabin has a 3-log knee wall, with whitewash, which measures ~2.4.0 high. The knee wall better retains period clay (mud) daubing. In a few areas, stone chinking is visible. The same daubing occurs between the rafter feet, where those meet the top log. The rafter feet rest on the top log without projecting over it. The roof frame consists of pole rafters, flattened on top, butted together at the roof's peak. The roof has circular sawn roofing boards, which are replacements that contain only a few wire nails. There is no evidence of finish (whitewash, nails or nail holes for interior siding) on the rafters. In that regard, the log cabin's garret was likely an unheated and minimally finished (whitewash on the knee wall) space, perhaps without windows (unless at the former, later removed north gable end wall).

The exterior chimney stack that was located along the south wall was removed in the modern era, leading to an insertion of a window (Window 3), with its frame utilizing wire nails. The gable end wall's 7 studs are round, are lapped onto the top log, and are spiked to the rafter with machine cut nails, later reinforced with wire nails. The north gable end wall had its exterior siding and wall studs removed during the addition of the frame structure. A doorway (Door 3) was constructed short of mid-way along the new "medial" wall (of 2 x 4's), along with framing for the wood stove flue immediately to the east.