

## Slave Housing Data Base

**Building Name:** Upperville Slave Quarter

**Evidence Type:** Extant

**City or Vicinity:** Upperville

**County:** Fauquier

**State:** Virginia

**Investigators:** Douglas W. Sanford, Mark Fesak, Sarah Rogers, Emily Bolesta

**Institutions:** University of Mary Washington

**Project Start:** 3/5/2016

### Summary Description:

The Upperville slave quarter is a 1½-story stone-and-frame building, with two exterior end chimneys, covered by a side-gabled roof, and supported on a continuous foundation of irregular stone coursing. The duplex structure measures 27.1.2 feet (N-S) by 17.4.0 feet (E-W), with a shed-roofed, one-story room appended to the southeast corner of the eastern façade. There are two entrances on the façade near the center of the structure. One appears to be in its original location, while the other has been altered, replaced by a window. The first floor contains two rooms separated by a central partition. Each room has a fireplace on the exterior end wall; both fireplaces have been filled in with stone and concrete. There are four windows downstairs, two in each room, with one window adjacent to their respective entrances on the eastern wall, and a smaller modern replacement casement window on the center of the western wall. The window on the eastern wall in the north room may be in an altered location, as there is some evidence that this was the original location of the door. The northern downstairs room includes a staircase leading up to the half-story. This staircase is a modern replacement but is likely in the original location.

The upper story consists of two rooms, separated by a central partition wall that appears to be original, judging by the hewn studs, but it has been covered with cardboard to simulate a solid wall. The doorway in this partition is a later addition. The exterior wall framing and roof framing on the upper story are all original. The collar ties are a post-Civil War addition. Each room on the upper story has an exterior end chimney, which has been infilled, with a 7"-diameter hole in the southern end chimney face to allow for a stovepipe. There are three windows in the southern room, with two on the southern wall on either side of the chimney stack, and one on the eastern wall near the partition. The northern room has two windows, one on the northern wall on the eastern side of the chimney stack, and one on the eastern wall near the partition. All of these windows have been replaced but are likely in their original locations.

Considering the sash sawn and pit sawn lumber, coupled with the mature machine cut nails, an estimated date of construction is between 1840 and 1860. The circular sawn lumber in the building was determined to be evidence of post-Civil War alterations.

**Principal Construction Type:** First story constructed of stone, frame upper story/garret.  
**One and One-Half Story**  
**Footprint:**

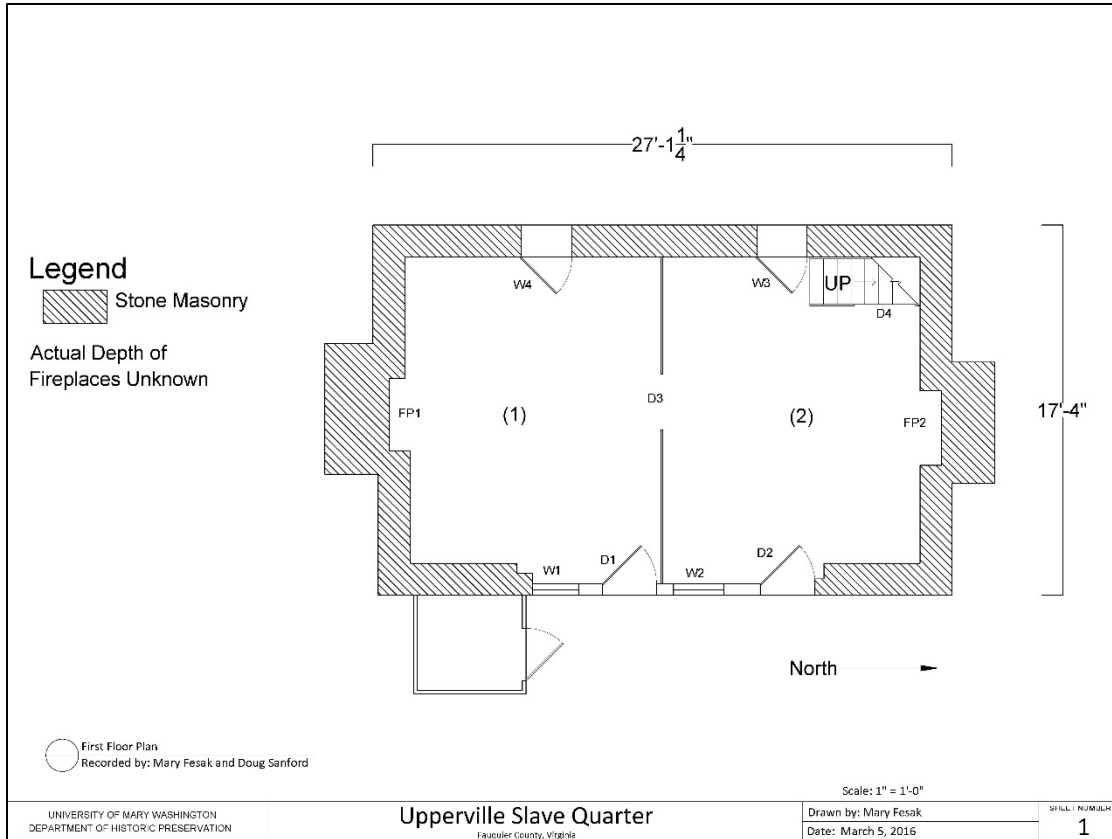

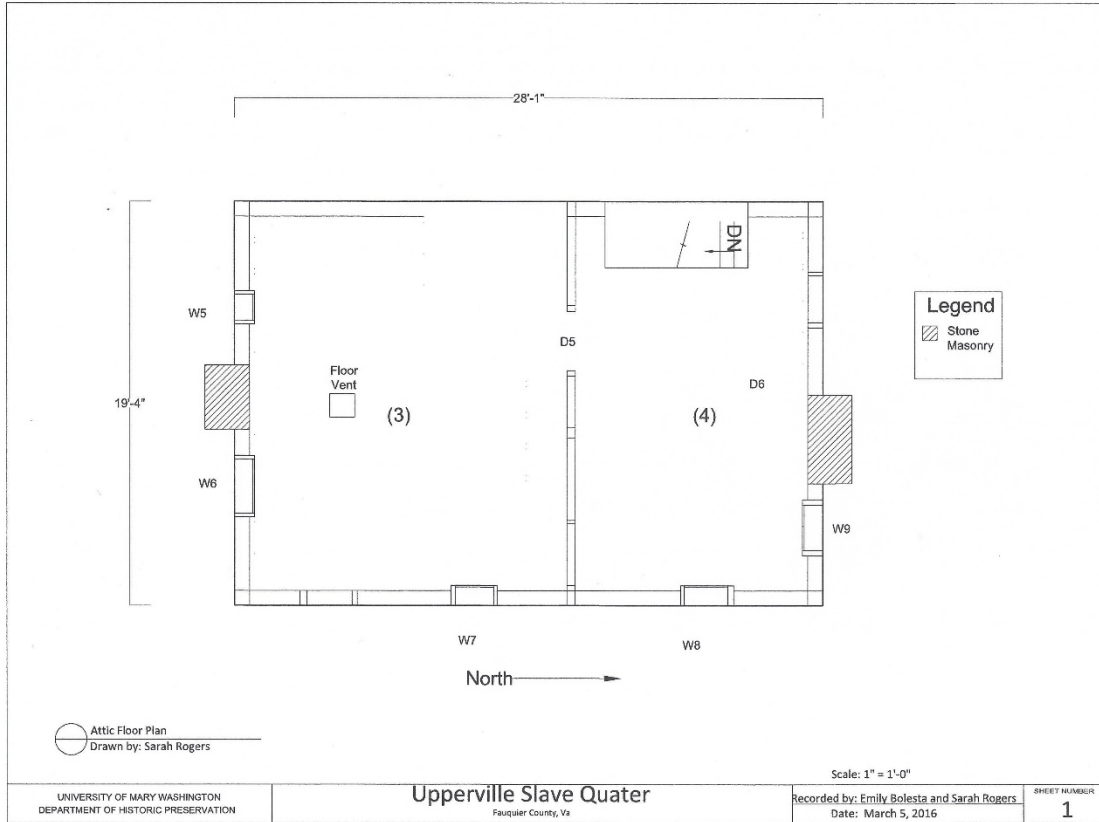

**Number of Rooms:** 4: 2 down, 2 up.

- Dimensions:** (1) 12.1.2 (N-S), 14.9.0 (E-W), 6.8.0 (Height to bottom of joists)  
 (2) 11.11.3 (N-S), 14.5.2 (E-W), 6.2.2 (Height to bottom of joists)  
 (3) 15.0.0 (N-S), 16.6.0 (E-W), 8.4.0 (H)  
 (4) 10.8.0 (N-S), 10.6.0 (E-W), 8.4.0 (H)

**Doors: 6**

	<b>(1)</b>	<b>(2)</b>	<b>(3)</b>
<b>Type:</b>	2 Panels Below, 2/2 Panes above	3 Panels Below, 2/2 Panes Above	Partition Doorway, No Door
<b>Dimensions:</b>	2.6.3 (W) x 6.0.0 (H)	2.7.0 (W) x 6.3.0 (H)	2.7.0 (W) x 6.2.0 (H)
<b>Hardware:</b>	5 Knuckle Butt hinge, brass knob.	5 Knuckle Butt hinge, brass knob.	N/A
<b>Swing:</b>	In	In	N/A
<b>Replacement:</b>	Yes, modern. Suspected original location	Yes, modern. Suspected original location	Later installation. Replacement partition.

**Doors, continued:**

	<b>(4)</b>	<b>(5)</b>	<b>(6)</b>
<b>Type:</b>	Stair Clear	Doorway, no central partition door.	Opening, no door.
<b>Dimensions:</b>	0.1.11 (W) x 3.8.1 (H)	2.9.0 (W) X 6.0.0 (H)	2.9.0 (W) X 6.1.0 (H)
<b>Hardware:</b>	N/A	None	None
<b>Swing:</b>	Out (into Room 2)	None	None
<b>Replacement:</b>	Yes	Later insertion	Modern partition doorway

**Windows: 9**

	<b>(1)</b>	<b>(2)</b>	<b>(3)</b>
<b>Type:</b>	6/6 Single Hung Sash	6/6 Single Hung Sash	Unknown. Original removed.
<b>Dimensions:</b>	2.3.1 (W) x 3.8.2 (H)	2.4.2 (W) x 3.10.1 (H)	Opening 2.3.2 (W) x 1.10.1 (H)
<b>Hardware:</b>	Thumb lock	Thumb lock	None
<b>Shuttered/ Slide/ Swing:</b>	N/A, Modern Replacement	Modern Installation. Possible original door location, note large posts to either side.	Opening originally 1.6.0 deep. Modern framing, circular sawn with wire nails with casement sash (removed)

**Windows, continued:**

	(4)	(5)	(6)
<b>Type:</b>	3/3 Casement	Single Pane, Casement	3/2 Casement
<b>Dimensions:</b>	2.4.2 (W) x 2.0.0 (H)	1.4.2 (W) x 2.6.0 (H)	2.6.2 (W) x 3.0.2 (H)
<b>Hardware:</b>	Modern 5 knuckle butt hinges	Wooden Latch	Wooden knob, metal hinge, screws
<b>Shuttered/ Slide/ Swing:</b>	Modern Replacement (original window opening)	Swing	Swing

	(7)	(8)	(9)
<b>Type:</b>	2/3 Casement	2/3 Casement	2/3 Casement
<b>Dimensions:</b>	2.2.0 (W) x 2.6.0 (H)	2.4.0 (W) x 2.6.0 (H)	2.7.0 (W) x 3.0.0 (H)
<b>Hardware:</b>	Wooden knob, metal hinge and screw	Wooden knob, metal hinge and screw	Wooden knob, metal hinge, screw
<b>Shuttered/ Slide/ Swing:</b>	Swing	Swing	Swing

**EXTERIOR**

**Foundation:**

**Continuous Masonry:** Field stone

**Bond:** Irregular coursing

**Mortar Type:** Tan sand and some red clay

**Repaired:** Yes, Portland cement

**Roof:**

**Roof Form:** Gable

**Roof Covering:** Sheet Metal

**Roof Framing:**

**Exposed:** Yes  
**Form:** Common Rafters  
**Rafter Number:** 11  
**Rafter Dimensions:** 0.2.2 (W) x 0.2.0 (H)  
**Collar Ties:** Yes, All later additions except for south gable end, one in from the chimney. No evidence of earlier collar ties that have been removed.  
**Collar Dimensions:** 0.3.0 x 0.1.0  
**Method of Joining:** Butted and spiked  
**Height from Roof Peak to Bottom of Collar Ties:** 1.9.0  
**Height from Top of Collar Ties to Floor:** 6.10.0

**Building Height:**

**Ground to Top of Stone Story:** SE corner 8.0.2, SW corner 5.1.2  
**Ground to Bottom of Eave:** SE corner 12.0.0, SW corner 9.1.2  
**Ground to Top of Eave:** SE corner 12.3.3, SW corner 8.9.0

**Walls:**

**Masonry:** Stone  
**Number of Courses:** Irregular coursing  
**Mortar Type:** Sand and clay  
**Joint:** Flush  
**Repaired:** Yes

**Chimney(s):**

**Chimney (1):** South Gable End  
**Material:** Stone 2.1.2 (N-S) X 6.2.0 (E-W)  
**Location:** Exterior – End  
**Height:** Part missing. Estimated 17.7.3  
**Chimney (2):** North Gable End  
**Material:** Stone  
**Location:** Exterior – End 2.1.0 (N-S) X 5.7.0 (E-W)  
**Height:** Part missing. Estimated 16.11.0

**INTERIOR**

**Wall Framing:** Exposed  
**Wall Finish:** Whitewash, originally on stone. Later plaster, paint layers. Second floor, modern plasterboard.

**Fireplace (1):** End

**Fireplace Material:** Stone  
**Fireplace Overall Dimensions:** N/A (Chimney construction blended with wall.)  
**Fireplace Opening Dimensions:** 3.6.0 (W) x 3.4.0 (H) – Depth unknown, filled with stone and cement.

**Hearth Material:** Concrete, likely replacement.  
**Hearth Dimensions:** 1.11.0 (N-S) x 5.6.0 (E-W)

**Fireplace (2):** End

**Fireplace Material:** Stone  
**Fireplace Overall Dimensions:** N/A (Chimney construction blended with wall.)  
**Fireplace Opening Dimensions:** 3.4.0 (W) x 2.7.2 (H) – Depth unknown, filled with stone and cement.

**Hearth Material:** Concrete  
**Hearth Dimensions:** 1.7.2 (N-S) x 4.5.0 (E-W)

**Stairs:** Yes

NW corner, Room 2

**Type:** Ladder

**Stairwell Dimensions:** 5.2.0 (N-S) x 1.8.3 (E-W)

**Number of Treads:** 8

**Stair Tread Dimensions:** 2.3.5 (L) x 0.7.3 (W) x 0.8.1 (H)

Replacement Stair, circular sawn, wire nails.

No earlier framing survives.

**Subfloor Pit:** No

**Floor:** Wood

**Floorboards Dimension:** NA -- Modern replacement covered with linoleum.

**Dating:**

**Dating Evidence:**

**Saw Marks:** Sash sawn

**Nails:** Mature machine cut

**Notes:**

*Room 1:* Original log joists in room 1 survive, with bark, in the round, with wide (14 in. - 16 in.) floor boards (running N-S) surviving on top of log joists. Log joists seen at central partition, at north edge of fireplace hearth, and at 5' south of partition log. Some stones remain for Room 1 fireplace/hearth box. Except for hewn ceiling joist at south end wall, all other joists are circular-sawn lumber. (2 ¼ in. x 6 in.) Likely a replacement of the entire upstairs floor, judging by the circular-sawn boards above, along with replacement windows, doors, and interior paneling of horizontal boards. Suggests wholesale rebuilding of interior, thus loss of evidence for original stairs.

*Room 2:* Floor joists look largely replaced with circular sawn lumber, although one log joist survives. Ceiling joists are circular sawn, likely replacements. Floor boards above are circular sawn. Joists 2.25 in. -2.5 in. wide x 3.7 in. high, 20 to 26 in. centers.

*Garret:*

Heavy timber framed, studs 26 in. apart. Thickness of studs is 2 in. – 3 in. Window box/frames are all replacement, circular sawn with wire nails. Original openings on east side.

*Room 3:* Eastern side of room has white painted rafters, hand hewn, probably replaced. Down bracing in corners is more recent, added when roof was redone, as evidenced by wire nails. There are two upbraces by the south chimney, also added when roof was redone. Studs along walls are mortised into plate and sill. There is a circular sawn wall covering on west wall, plasterboard on other walls. There is a vent in floor of Room 3/ceiling of room 1. The hole in the chimney in both Room 3 and Room 4 is 7" in diameter to allow for a woodstove. It is a fieldstone chimney. Siding is circular sawn.

*Room 4:* Chimney is flush with drywall. Drywall is a modern addition, and most walls are cardboard on scrap wood. The partition wall of Room 4 is a modern addition. The middle partition is original- it has pit sawn and sash sawn marks on framing, mortise and tenon joints, now covered in cardboard. Roofing boards are replaced, circular sawn with wire nails. There is some plastering over the north chimney. Collar ties are circular sawn and sash sawn, and are later additions. There are hand hewn studs along walls of building. There are two modern closet additions.

*Garret Partition:* The partition on the second floor was built in 3 primary phases. In phase 1 the pit sawn studs numbered 2, 4, and 5 (when viewer is facing south, starting from the left) were added. The rail is mortised into these vertical posts on the north side of stud 2, and on the south side of studs 4 and 5, as well as the east and west walls of the building. The rail appears to be pit sawn on top, but appears to be circular sawn on the side. There are machine cut nails visible in the rail and on stud 2. Phase 2 saw the addition of stud 3, which is circular sawn with large wire nails. The rail is nailed into the south side of the post. The central support goes all the way to the roof peak. During phase 3, a new roof and collar ties were added. The rail was cut between studs 4 and 5 to make a door opening (D5). The baseboard was not notched into the studs.